

SCOPE OF APPLICATION | APPLICATION  
Design changes of M8 and M12 adapter

CURRENT DESIGN

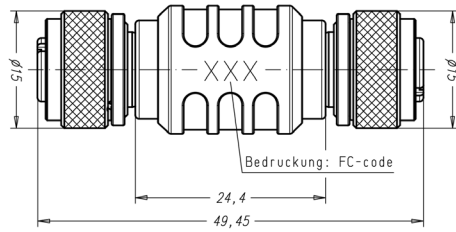

NEW DESIGN

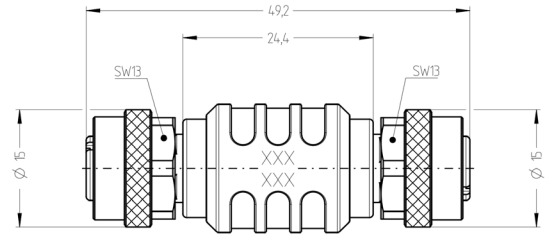

M12 FEMALE > M12 FEMALE

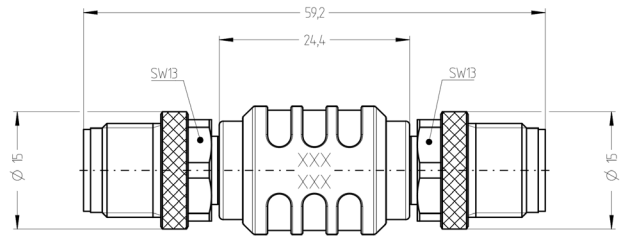
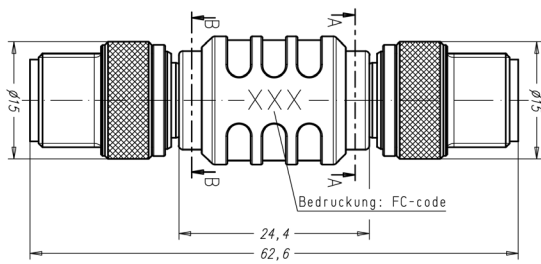

M12 MALE > M12 MALE

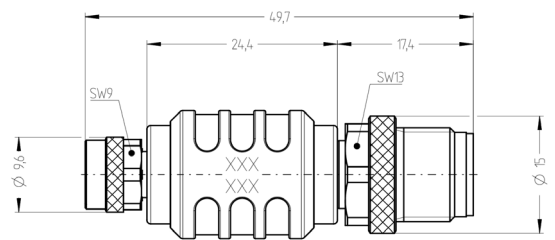
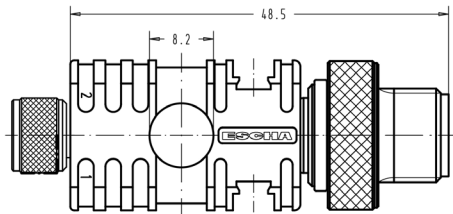

M8 FEMALE > M12 MALE

## MODIFICATION

In order to ensure long-term and secure delivery capability, ESCHA has decided to adapt some products to standard components. External dimensions are only slightly affected.

- Hexagon coupling nut with knurl
- Black overmolding
- White marking (e.g. logo, item-description)

## CONFIRMATION OF WARRANTED CHARACTERISTICS

All guaranteed electrical- and mechanical characteristics are not affected by these modifications.

## DATE OF MODIFICATION

- The changes will be implemented on 01 January 2023
- Mixed deliveries may occur as the item numbers remain the same so stock and changed products may be included in the same shipment

## PORTFOLIO EXPANSION

As part of the changes, two additional products will be part of the portfolio.

- Adapter M8 female 4 poles to M8 male 3 poles
- Adapter M8 female 3 poles to M8 male 4 poles

## AFFECTED ITEMS

See detached Excel file

Director Product Management

Marc Braun

Compliance Officer

Quality Management Representative

Achim Rudack